

CHASSIS GALANDAGE AUSTRAL

1 RAIL, 2 RAILS ET 3 RAILS



DOCUMENTATION TECHNIQUE

Dormant 1 rail Y1740009

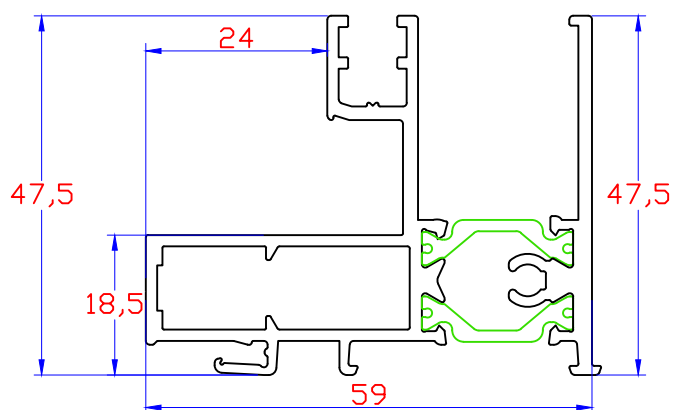

Rail rapporté Y3740011

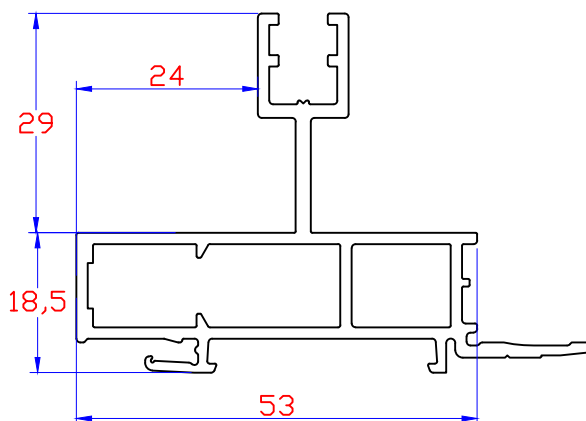

Dormant 2 rails Y1740010

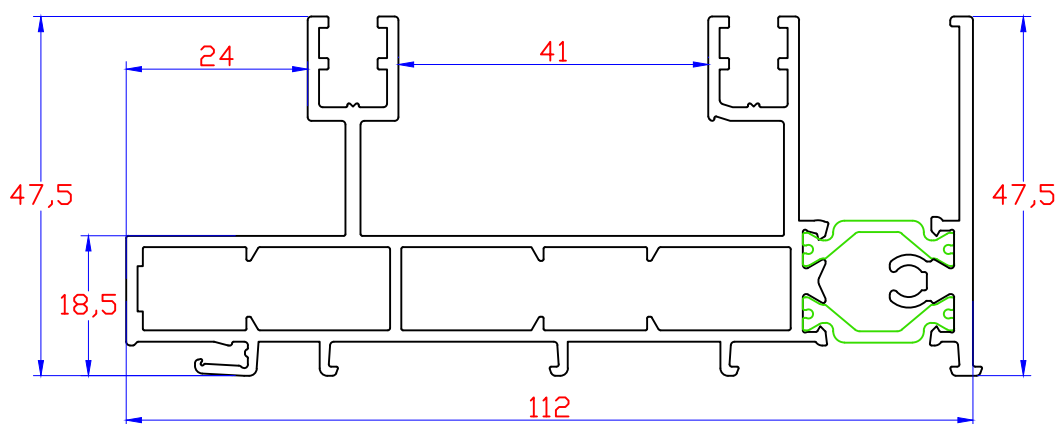

Rail Inox



**Rail Alu
3041224.1776**



**Garde à l'eau
W3090208**

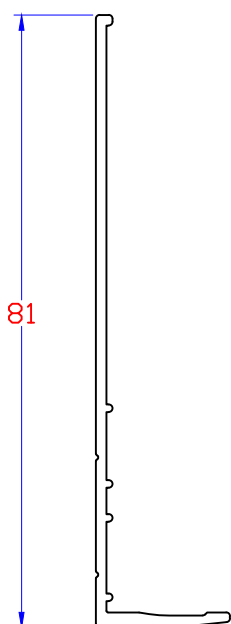

**Cunette garde à l'eau
Y3740017
(préperçée)**

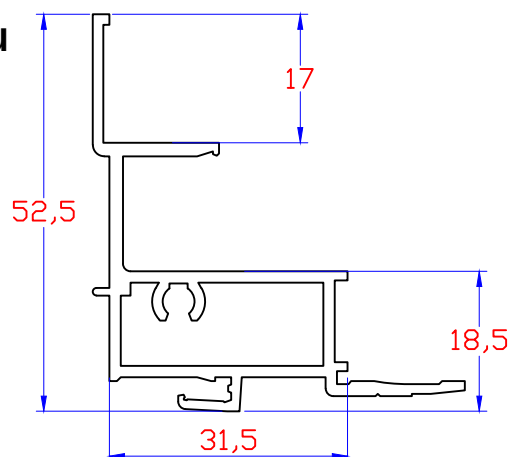

**Appui
W4000169**

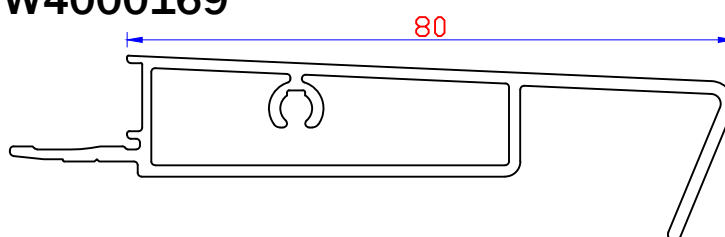

Echelle 1:1

Chicane fixe Galandage
Y3740003

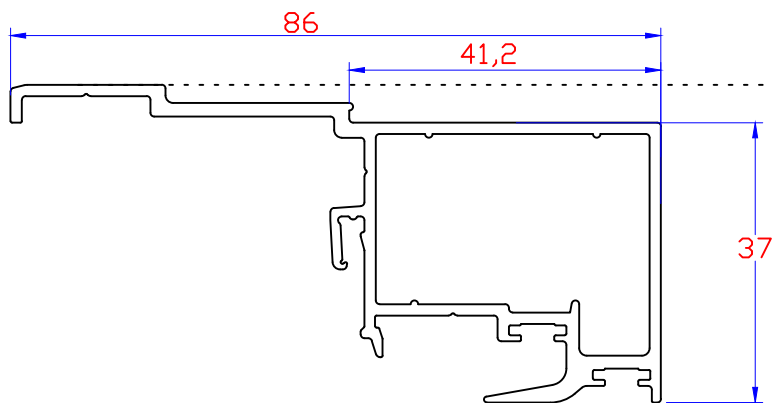

Tapée galandage
(préperçée)
Y3740012

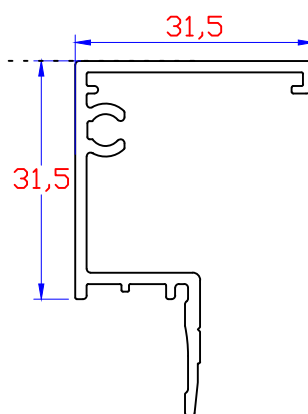

Chicane fixe Galandage VR
Y3740018

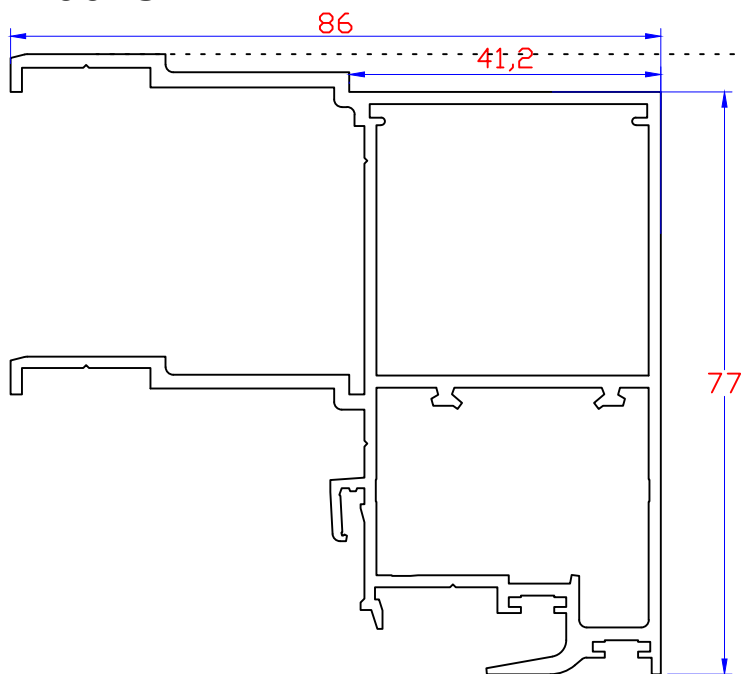

Tapée Galandage VR
(préperçée)
Y3790024

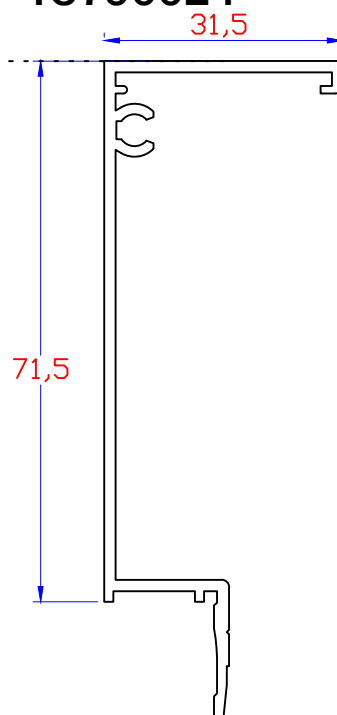

**Tapée habillage
intérieur
Y3790002**

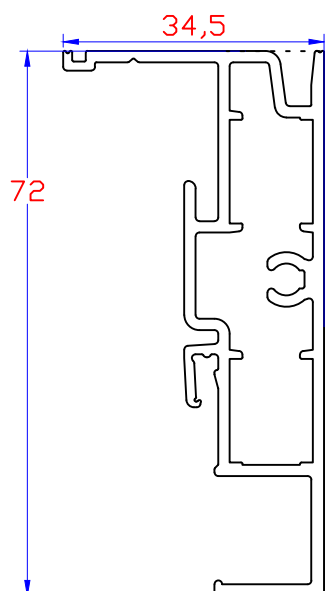

**Agrafe
SP27507**

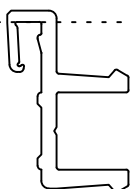

**Capot Habillage
Y3740004**

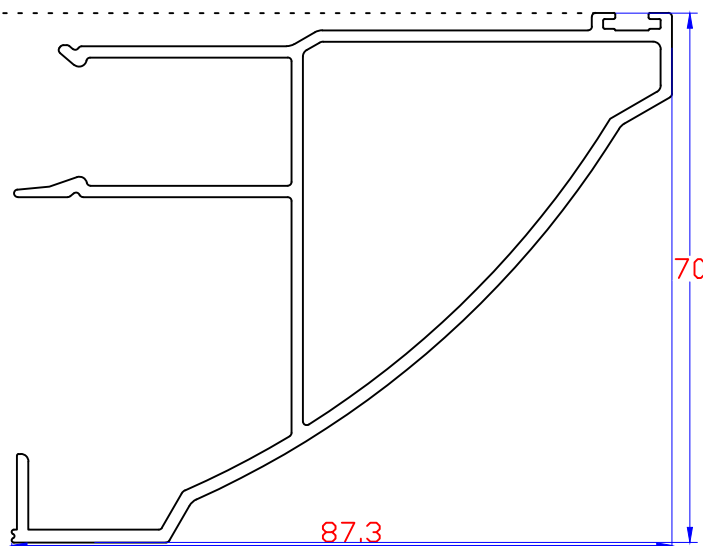

DOCUMENT NON CONTRACTUEL SUSCEPTIBLE D'ÊTRE MODIFIÉ

**Bouclier + capot intégré
Y37A0029 noir**

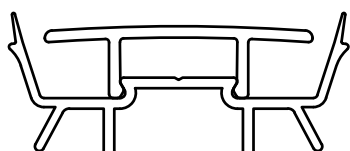

**Capot Bouclier
Haut & Bas
W4030240**



**Bouclier Drainé
Haut & Bas
W4030239**

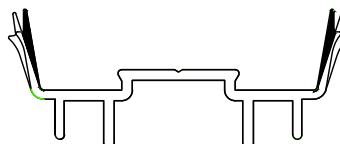

**Barreaudage
XR50302**

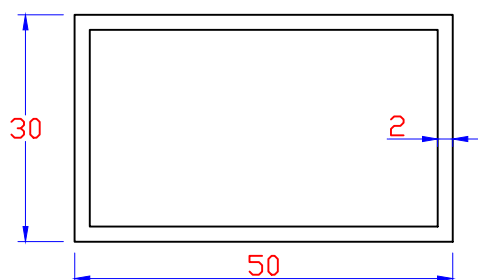

**Brosse Haute
W4010503**

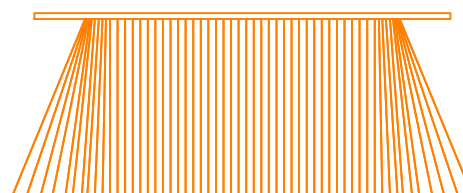

**Capot Montant
Gauche & Droite
W4030241**

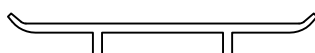

Echelle 1:1

**Ouvrant latéral simple
W1041270**

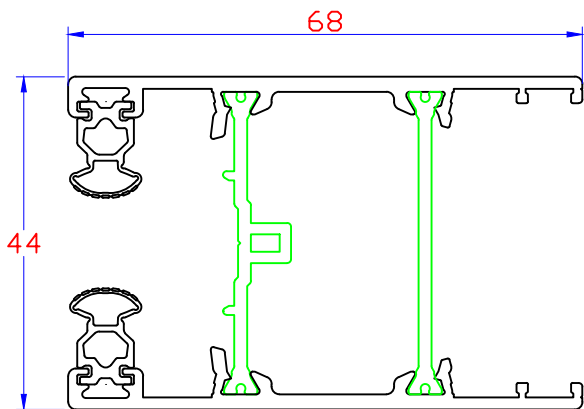

**Ouvrant renforcé
Galandage 2 vtx
W1041272**

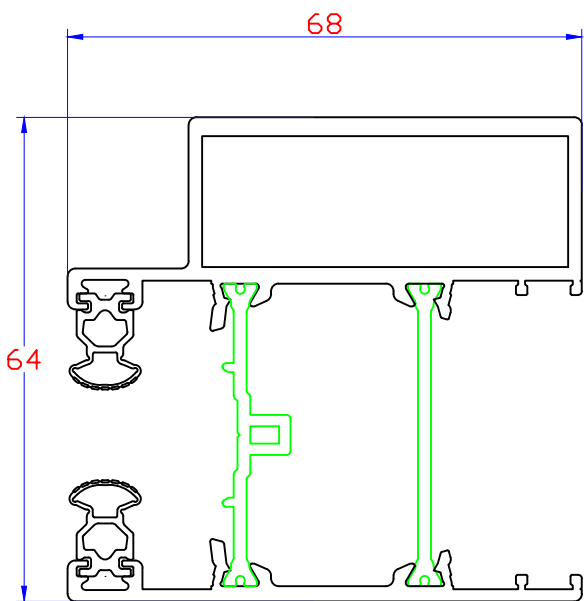

**Chicane
W4030243**

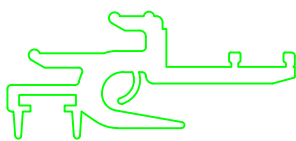

**Jonction vantaux en ligne
W3041249**

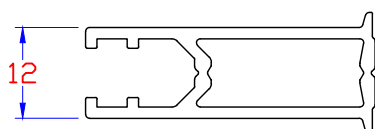

**Traverse haute et basse
W1041274**

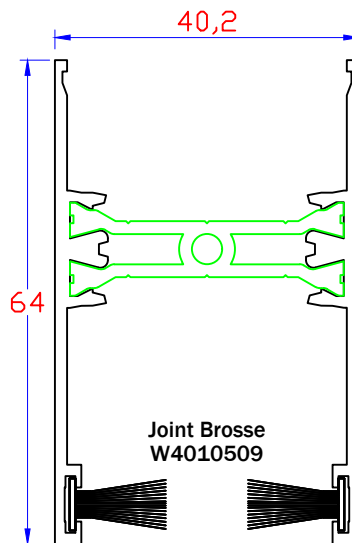

**Ouvrant
Galandage 2 vtx bi-rail**

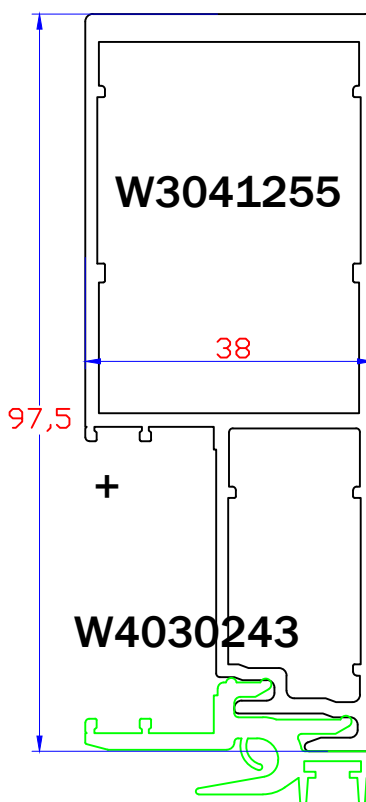

Ouvrant Central

**Y37A0001 =
W3041250
+
W4030243**

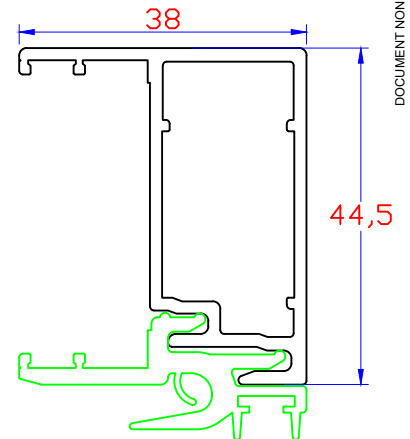

**Ouvrant central
carré
Y37A0007**

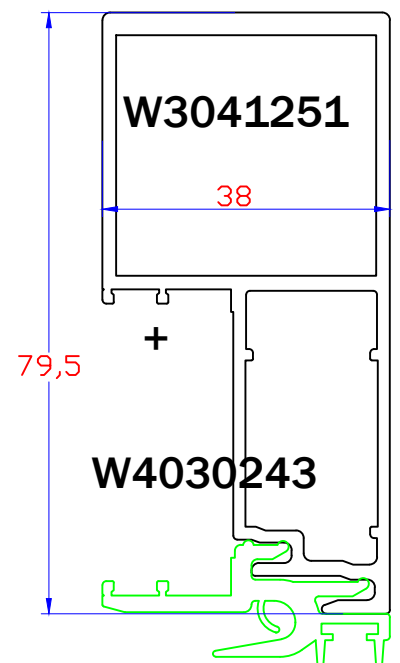

DOCUMENT NON CONTRACTUEL SUSCEPTIBLE D'ÊTRE MODIFIÉ

Echelle 1:1

Vue en coupe sur montant latéral galandage 1 vantail

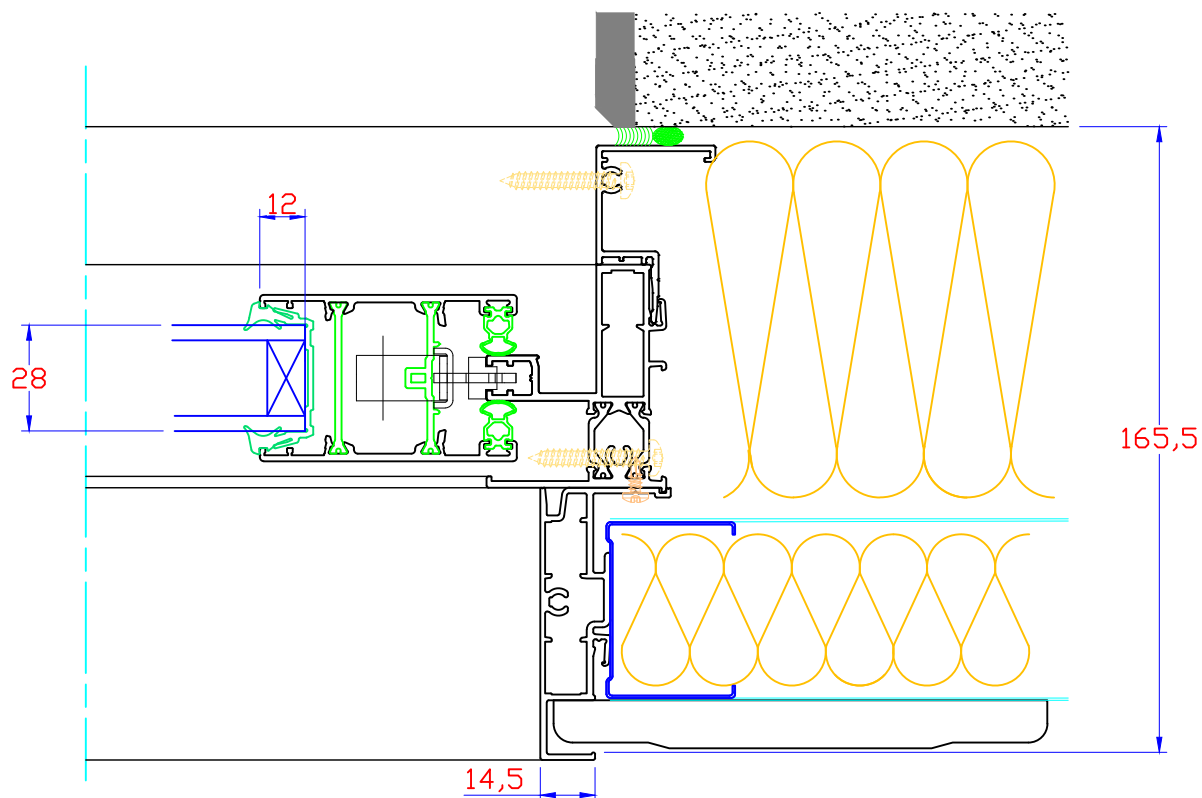

Vue en coupe sur montant côté refoulement galandage 1 vantail

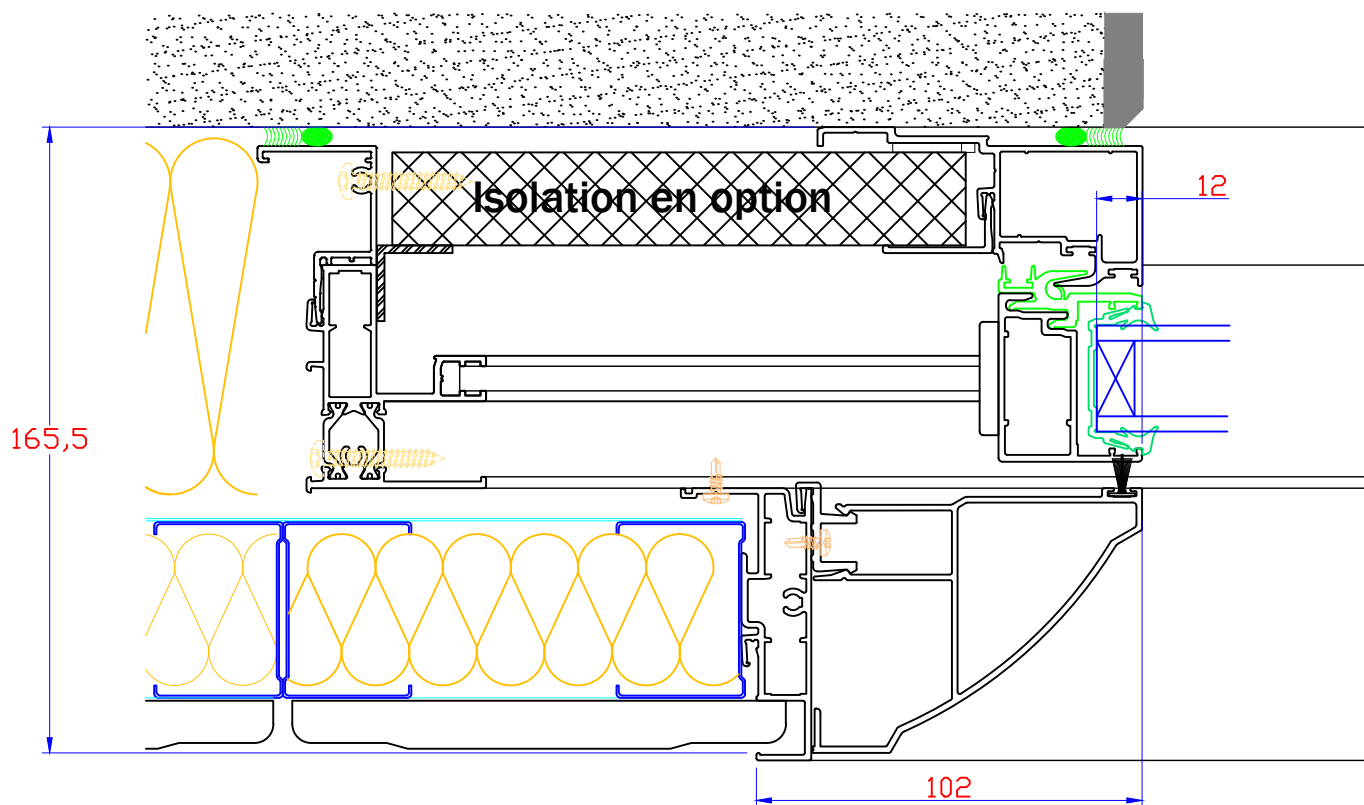

Echelle 1:2

Vue en coupe sur traverse haute galandage 1 vantail

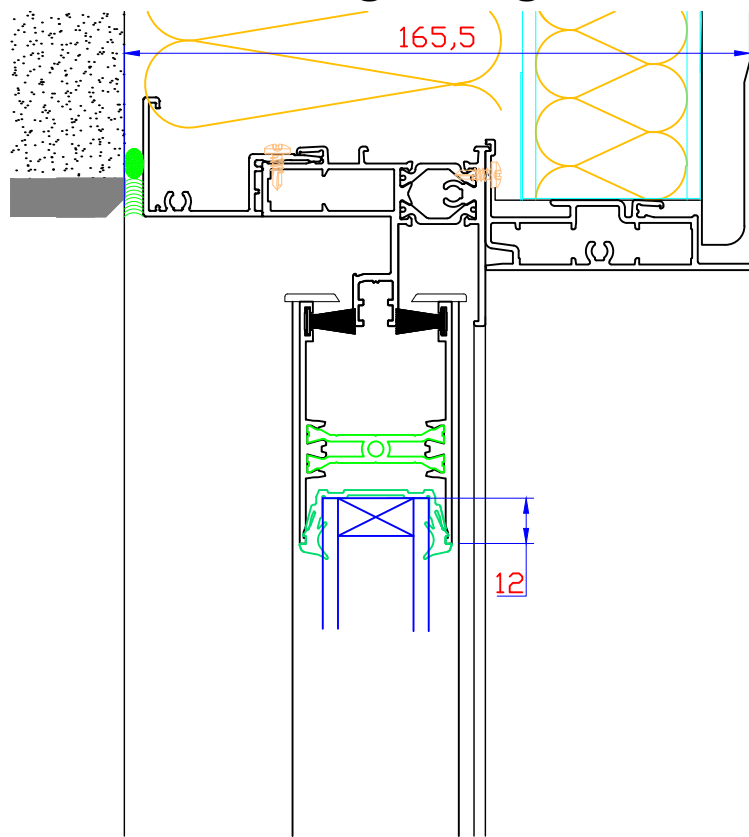

Vue en coupe sur traverse basse galandage 1 vantail

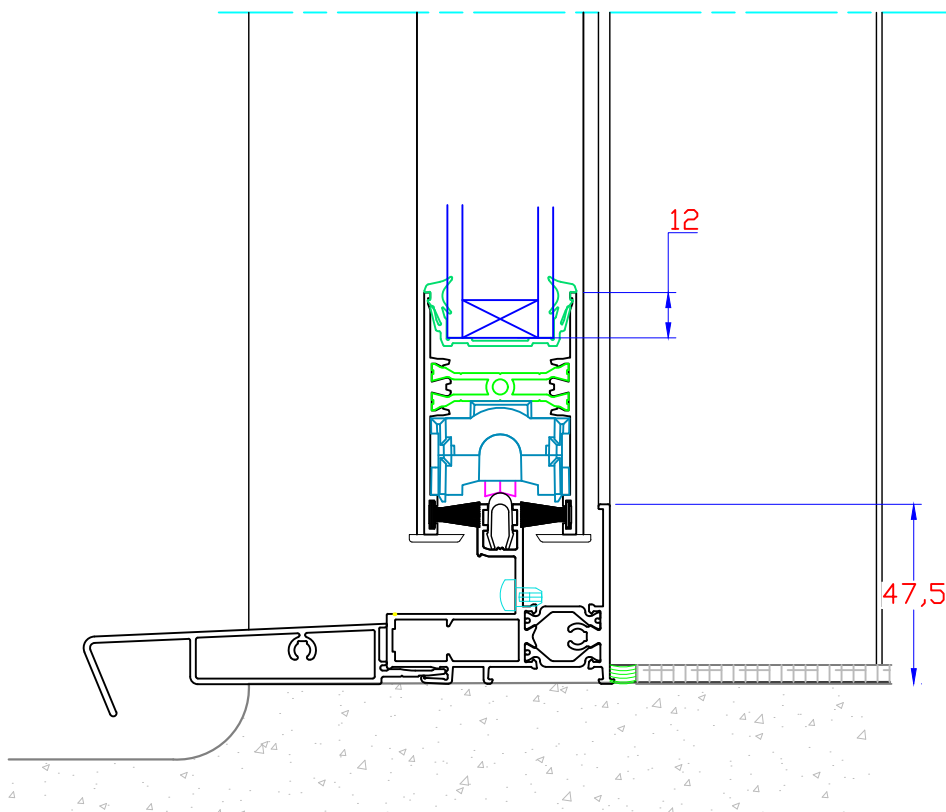

Mise en oeuvre seuil standard

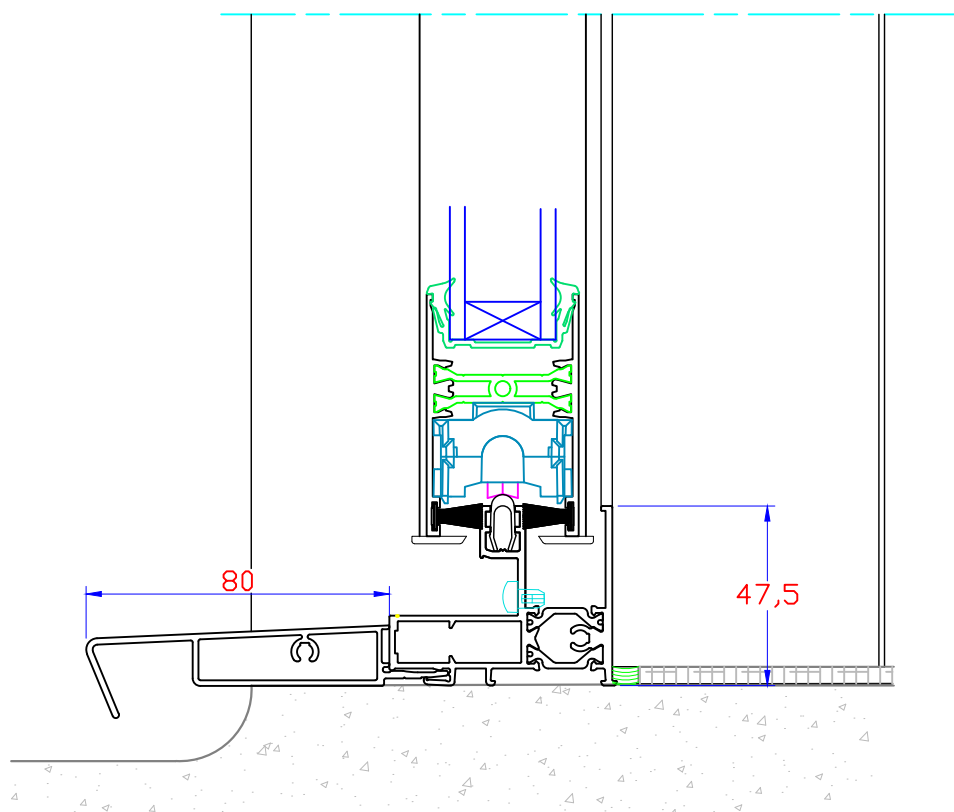

Mise en oeuvre seuil encastré

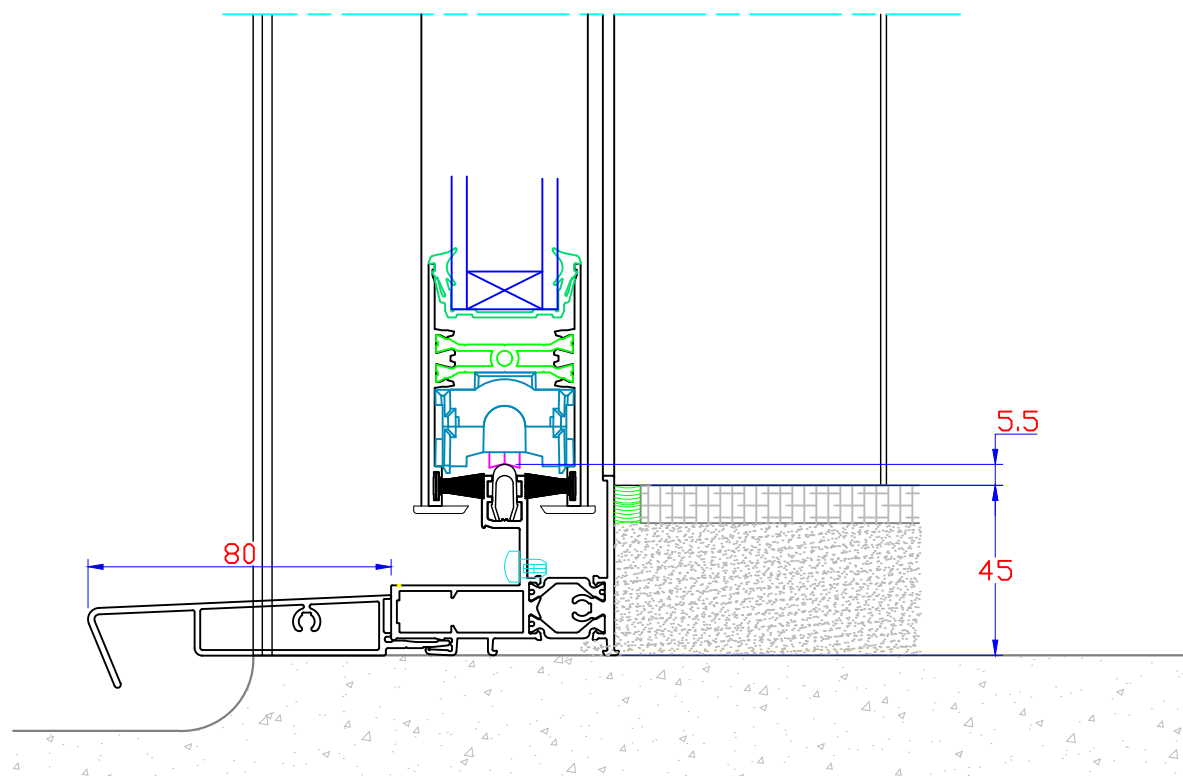

Vue en coupe horizontale galandage monorail 1 vtl doublage 160 mm

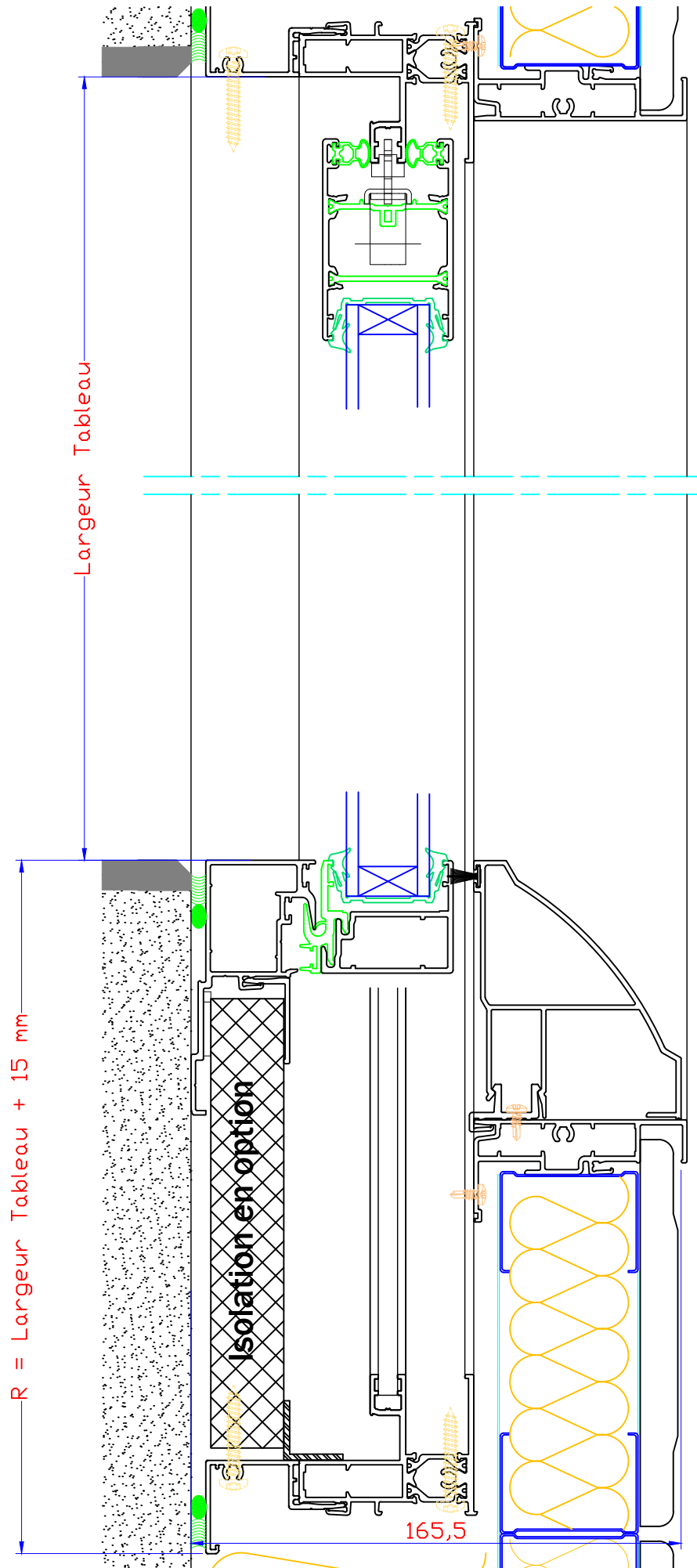

Echelle 1:2

Vue en coupe horizontale galandage monorail 1 vtl doublage 200 mm

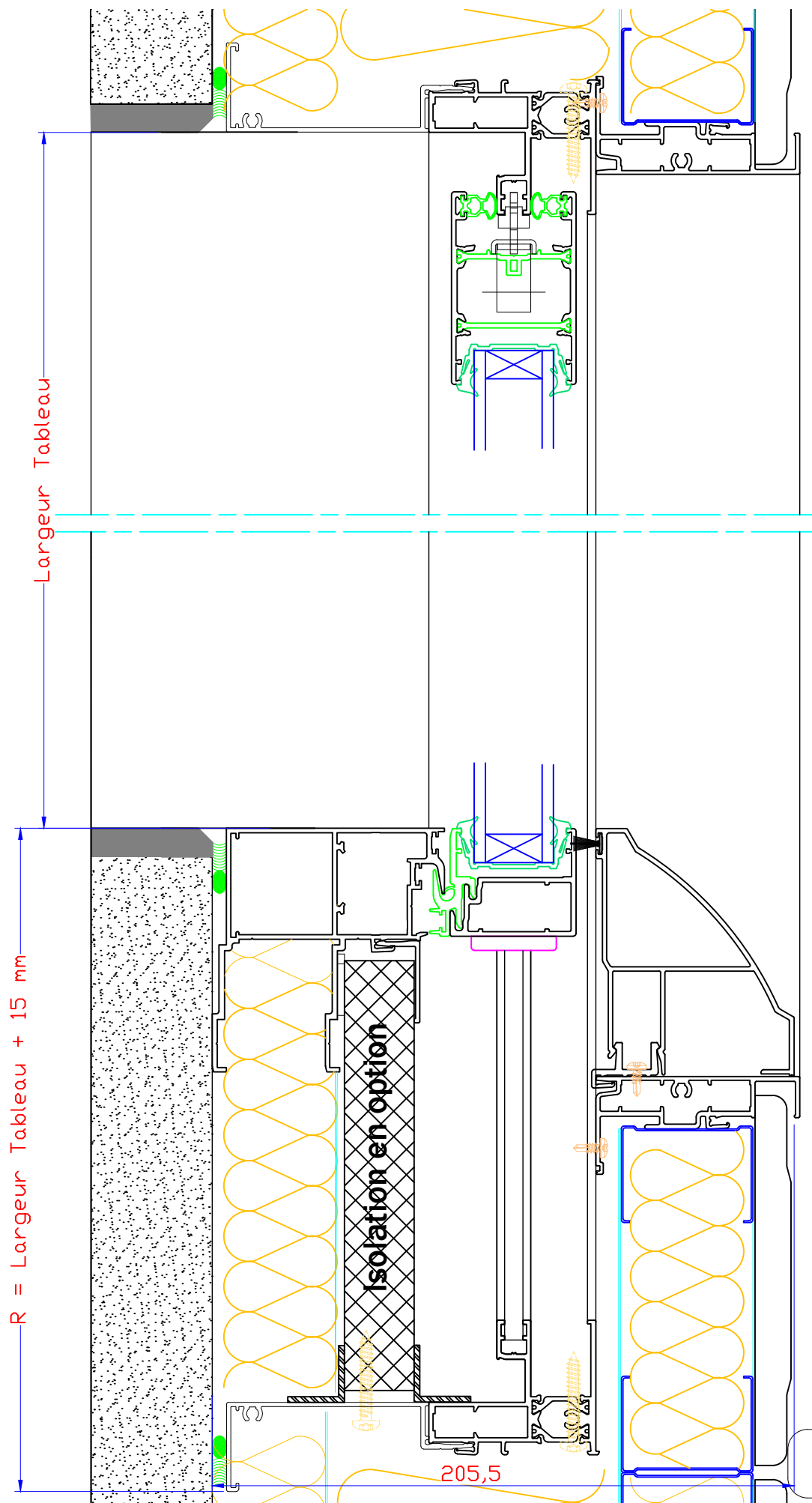

Echelle 1:2

Vue en coupe horizontale galandage monorail 1 vtl doublage 160 mm avec VR

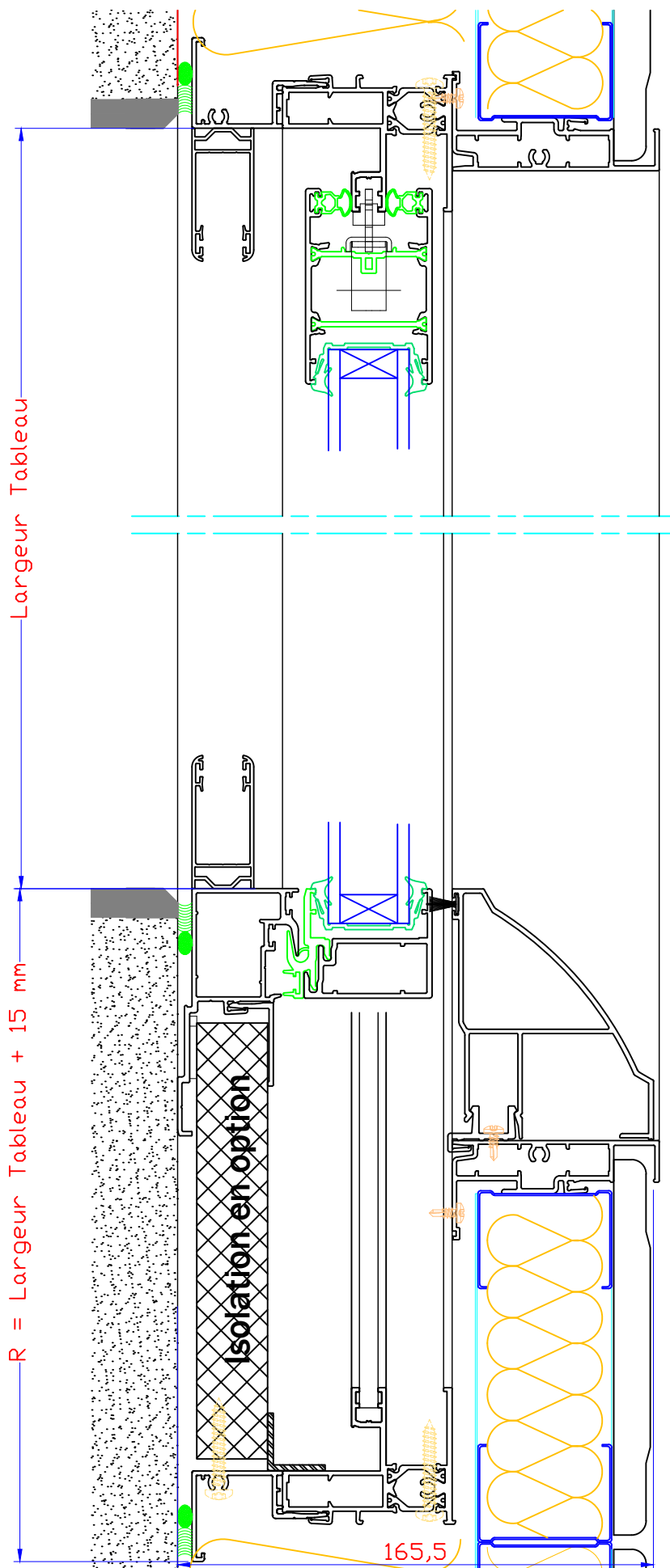

Echelle 1:2

Vue en coupe horizontale galandage monorail 1 vtl doublage 200 mm avec VR

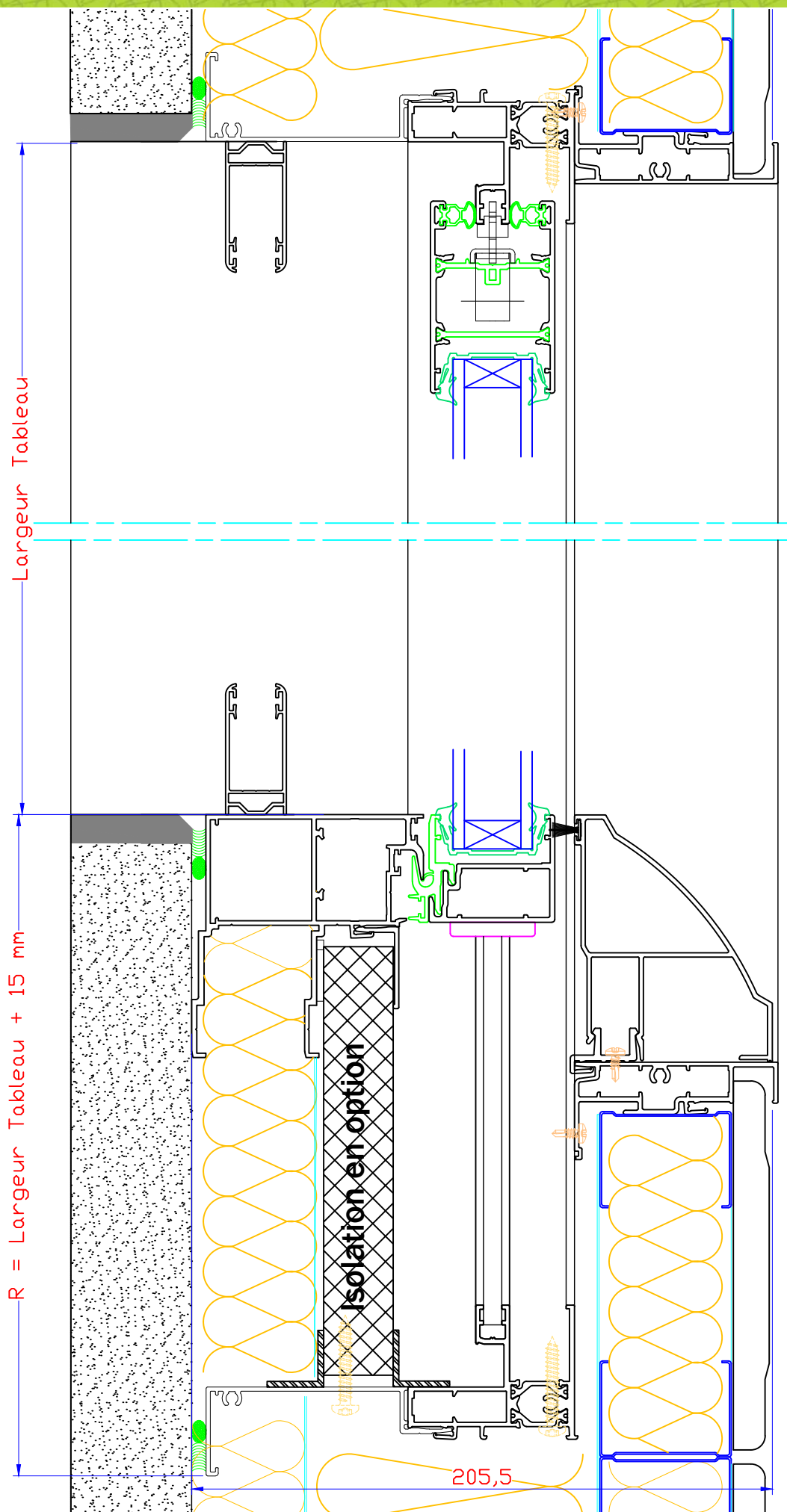

Echelle 1:2

Vue en coupe horizontale galandage monorail 2 vtx doublage 160 mm

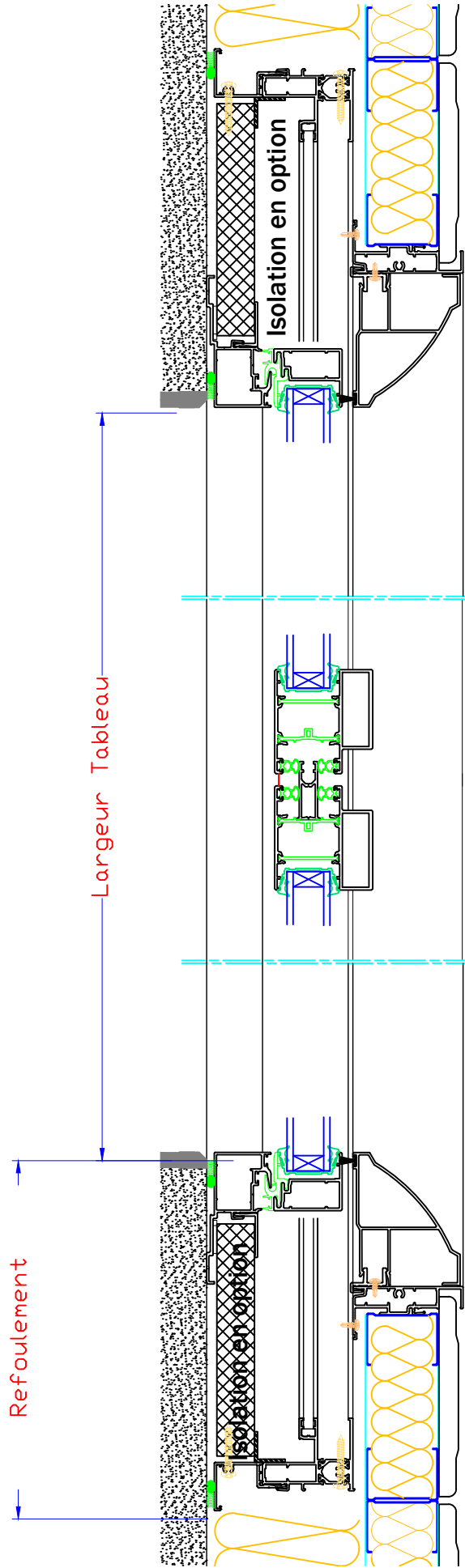

**Refoulement =
(largeur du tableau / 2)
+15mm**

Echelle 1:4

Vue en coupe horizontale galandage monorail 2 vtx doublage 200 mm

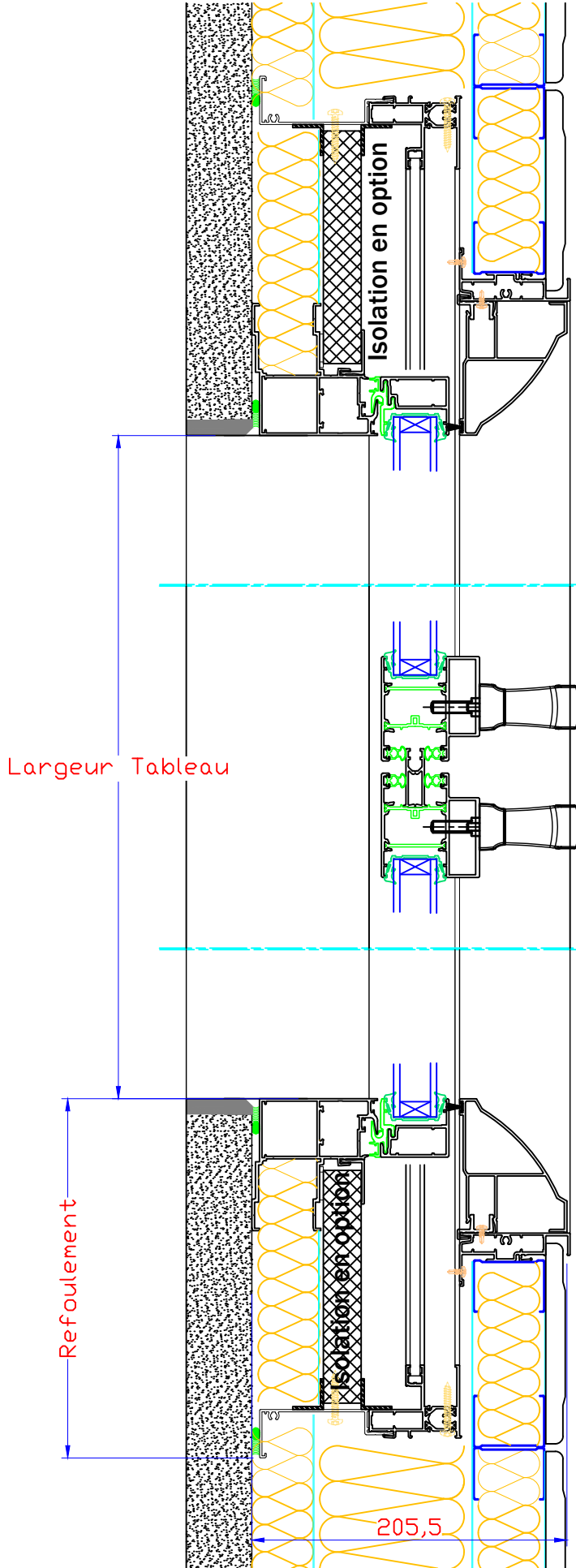

**Refoulement =
(largeur du tableau / 2)
+15mm**

Echelle 1:4

Vue en coupe verticale galandage monorail 1 vtl doublage 160 mm

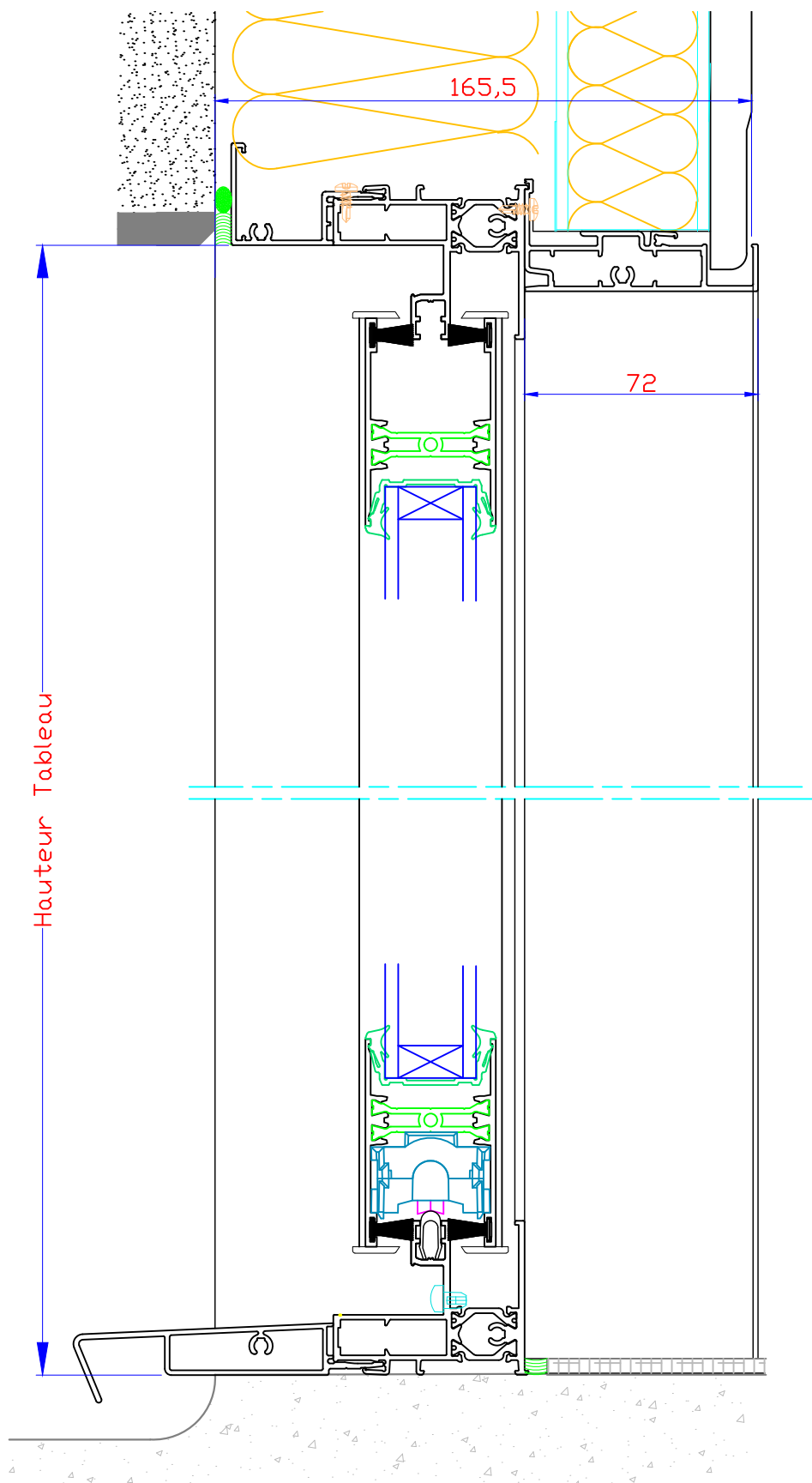

Echelle 1:2

Vue en coupe verticale galandage monorail 1 vtl doublage 200 mm

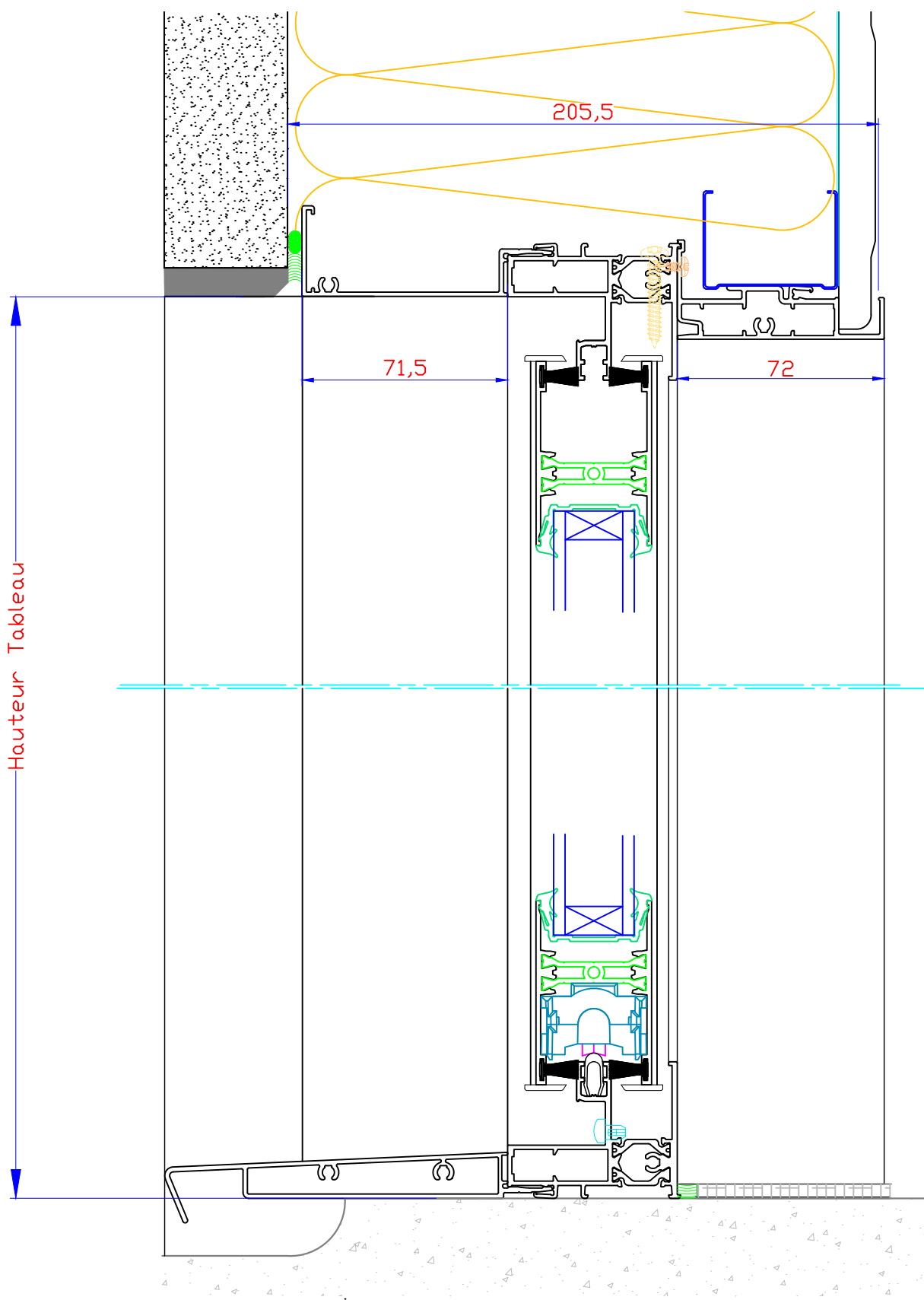

Vue en coupe verticale galandage monorail 1 vtl doublage 160 mm avec CVRI

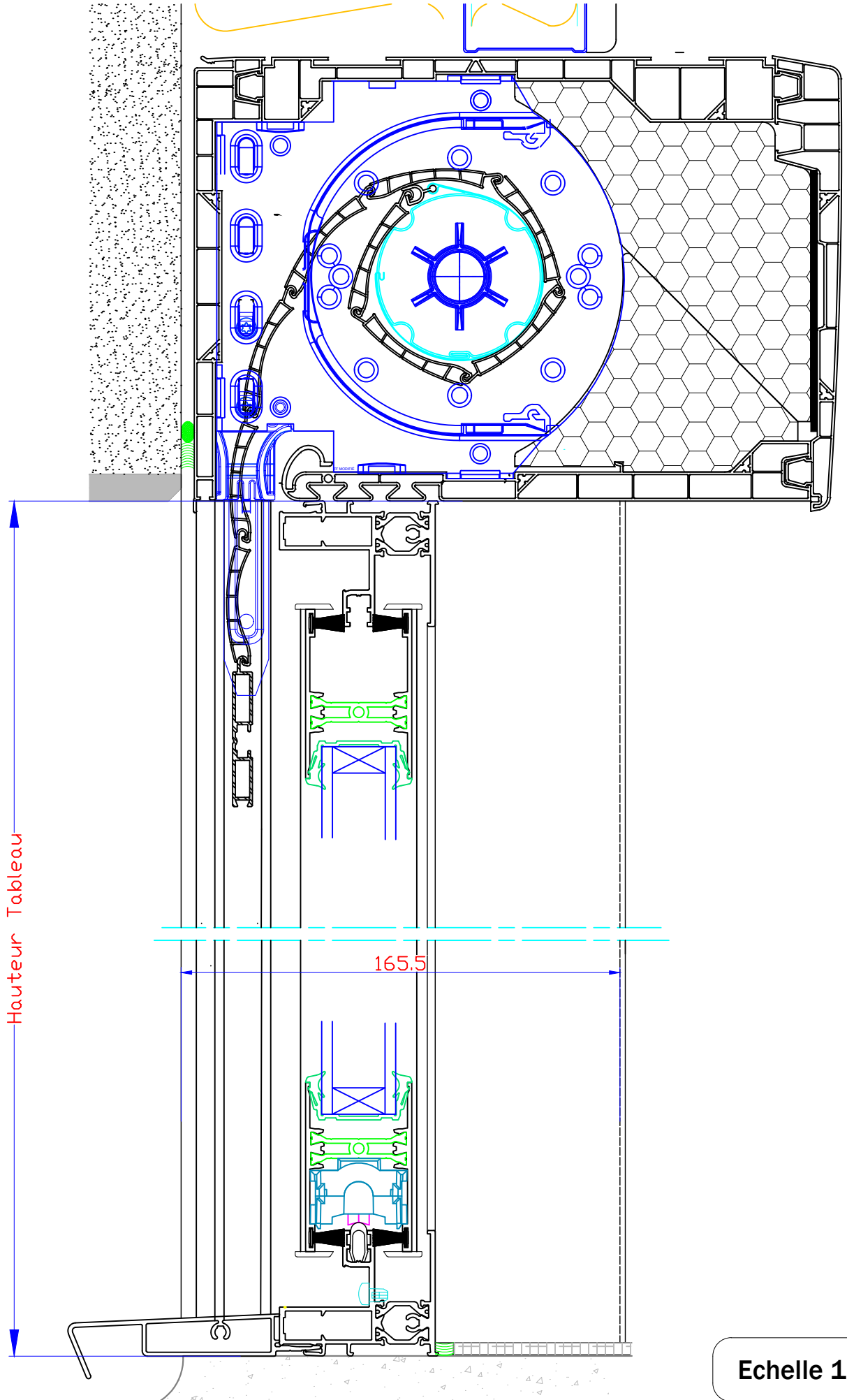

Echelle 1:2

Vue en coupe verticale galandage monorail 1 vtl doublage 200mm avec CVRI

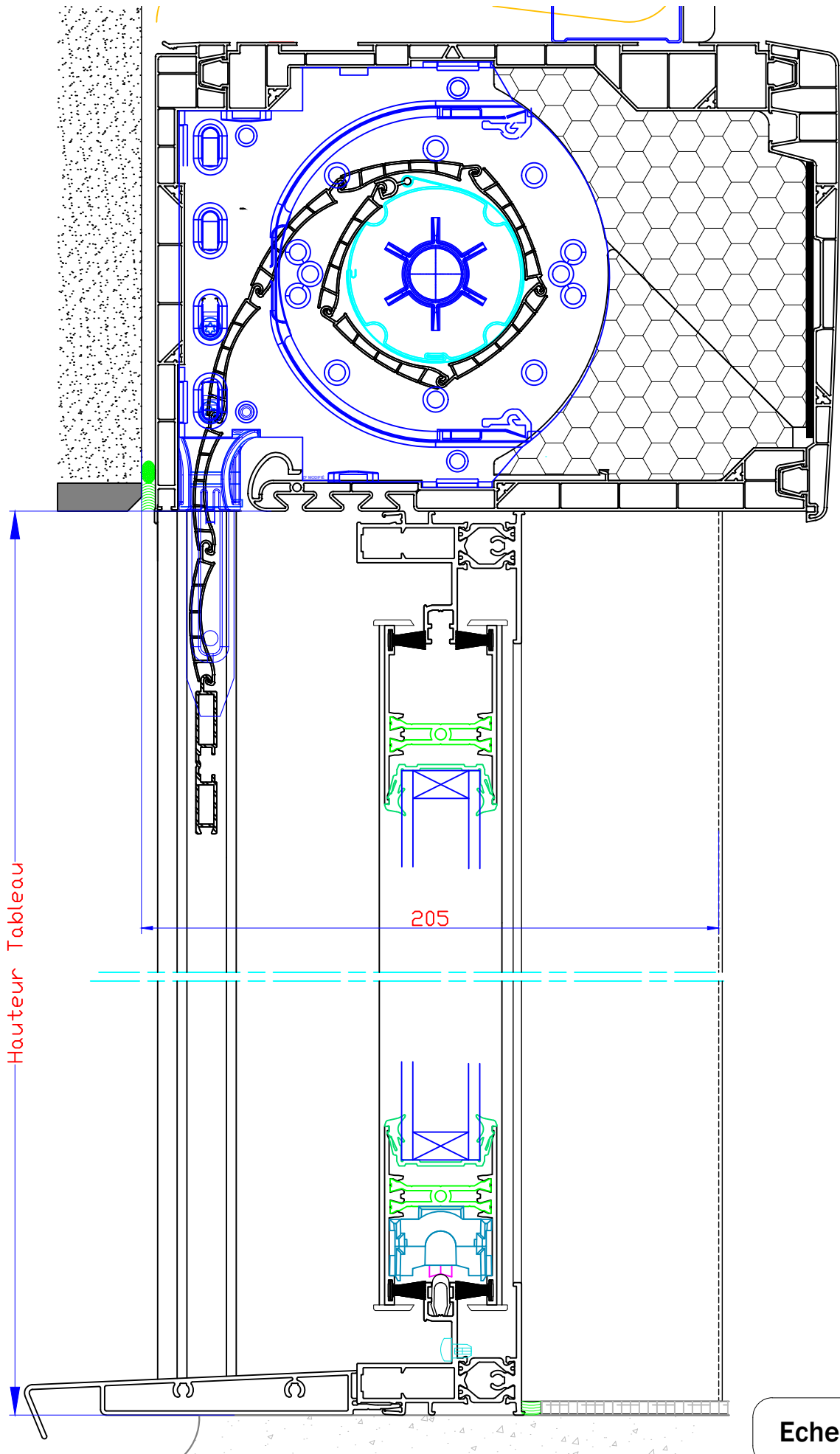

Echelle 1:2

Vue en coupe horizontale galandage bi-rail 2 vtx doublage 210 mm

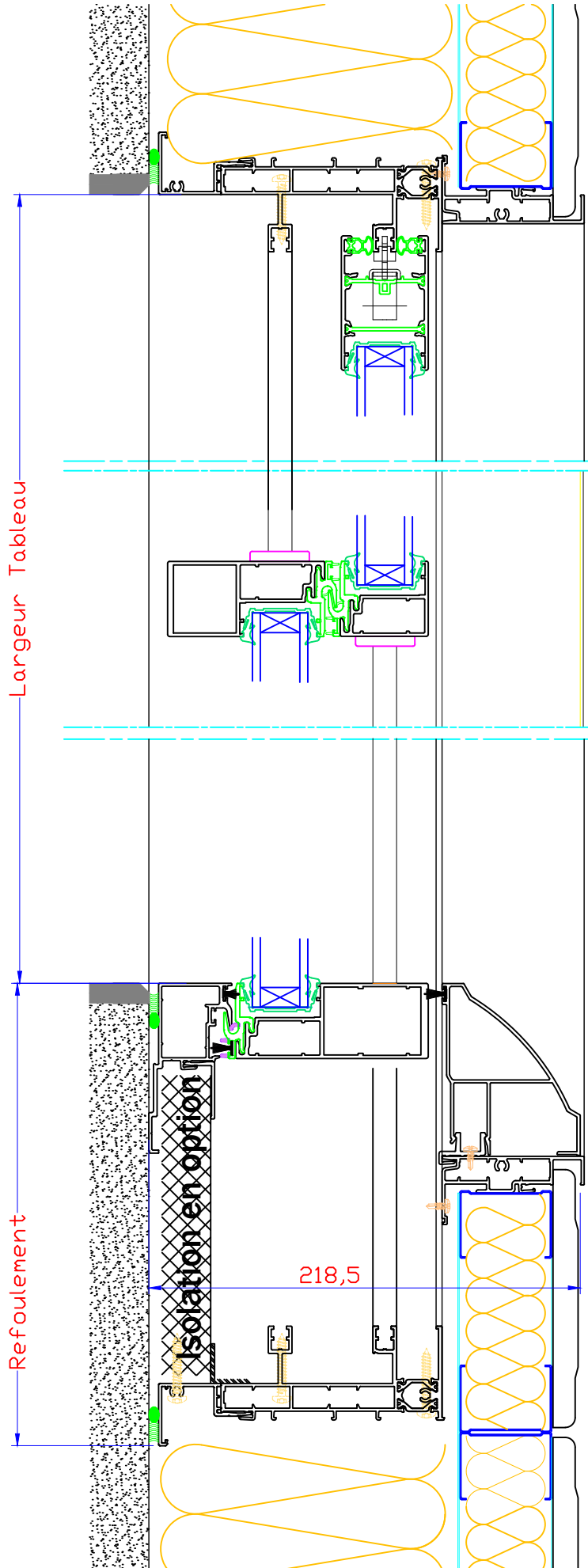

**Refoulement =
(largeur du tableau / 2)
+20mm**

Echelle 1:3

Vue en coupe horizontale galandage bi-rail 2 vtx doublage 250 mm avec VR

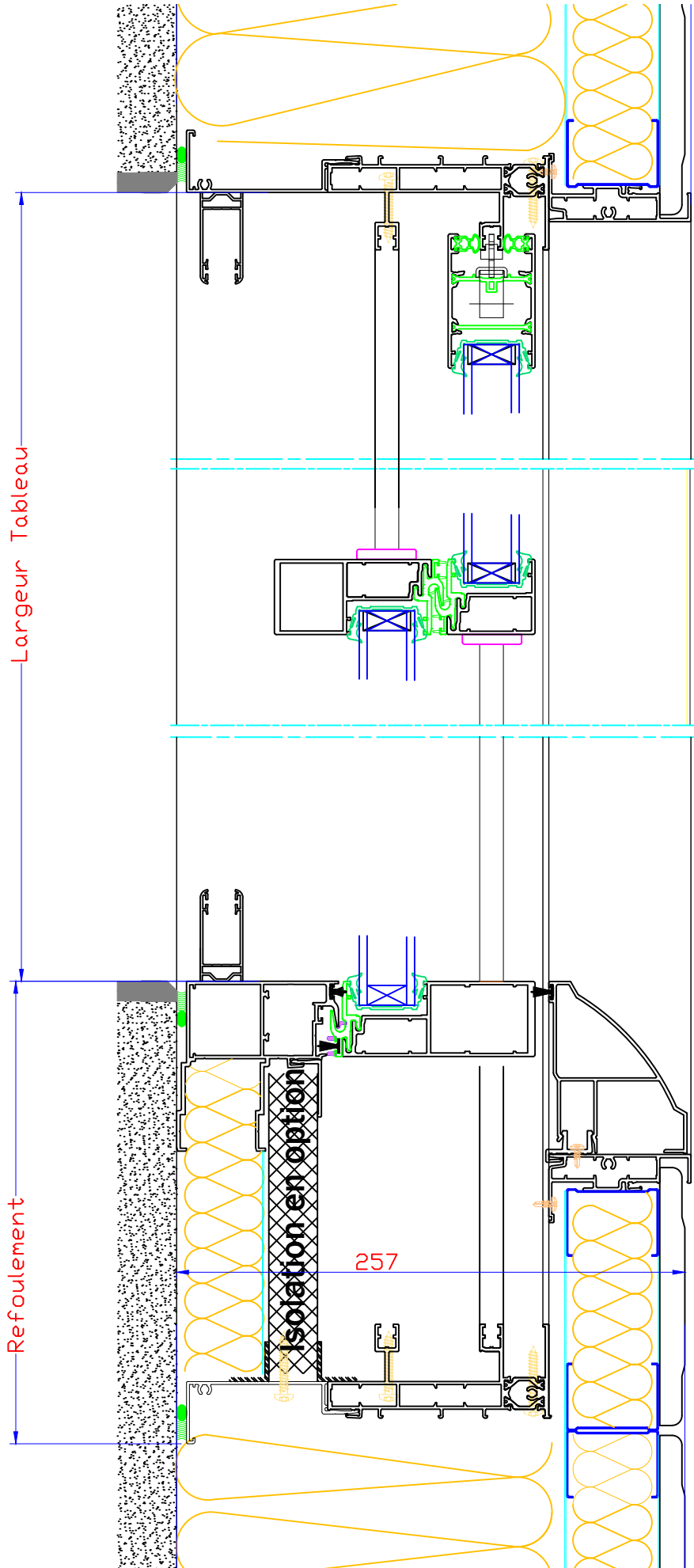

**Refoulement =
(largeur du tableau / 2)
+20mm**

Echelle 1:3

Vue en coupe verticale galandage bi-rail 2 vtx doublage 210 mm

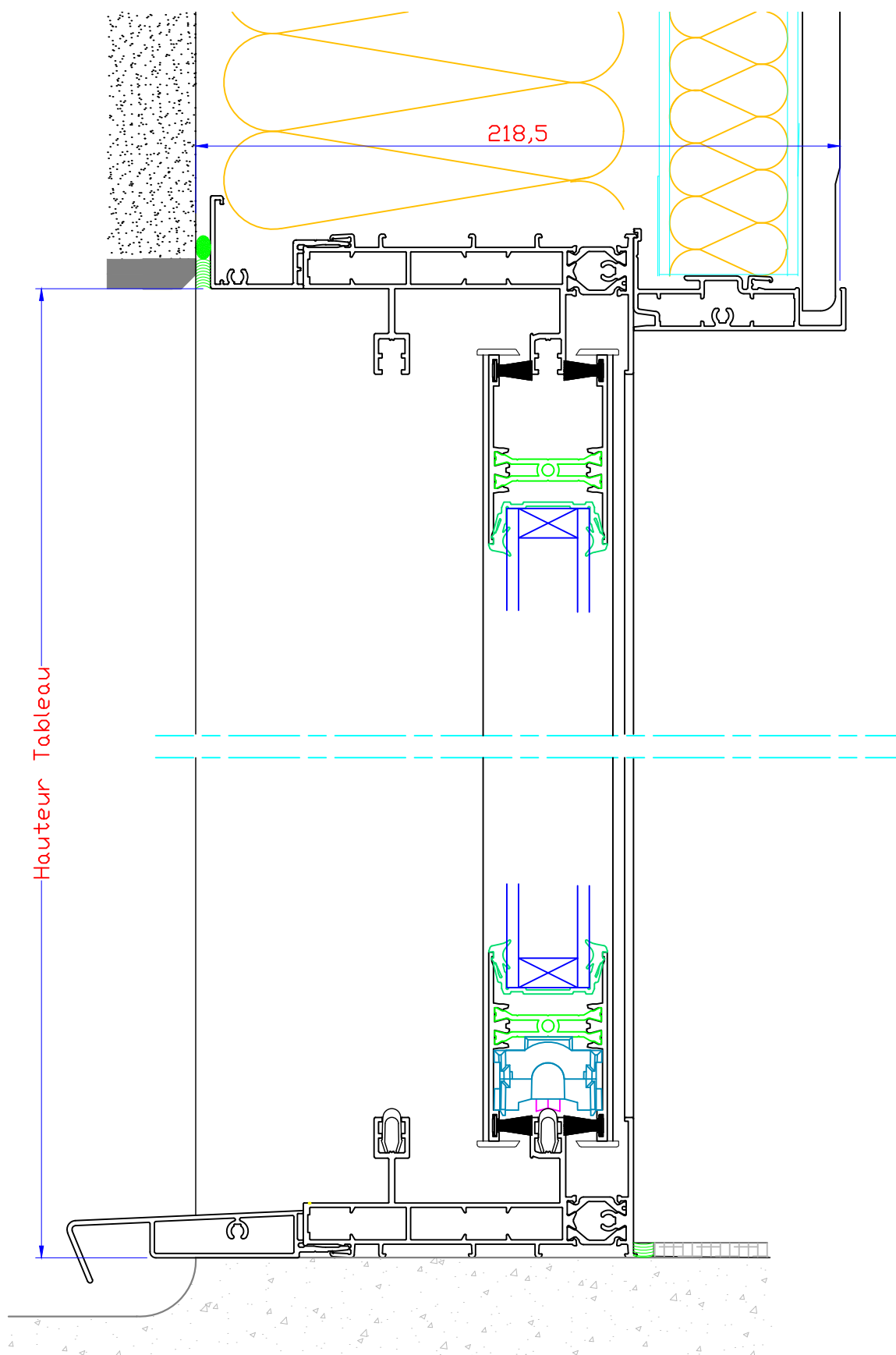

Vue en coupe horizontale galandage bi-rail 4 vtx doublage 210 mm

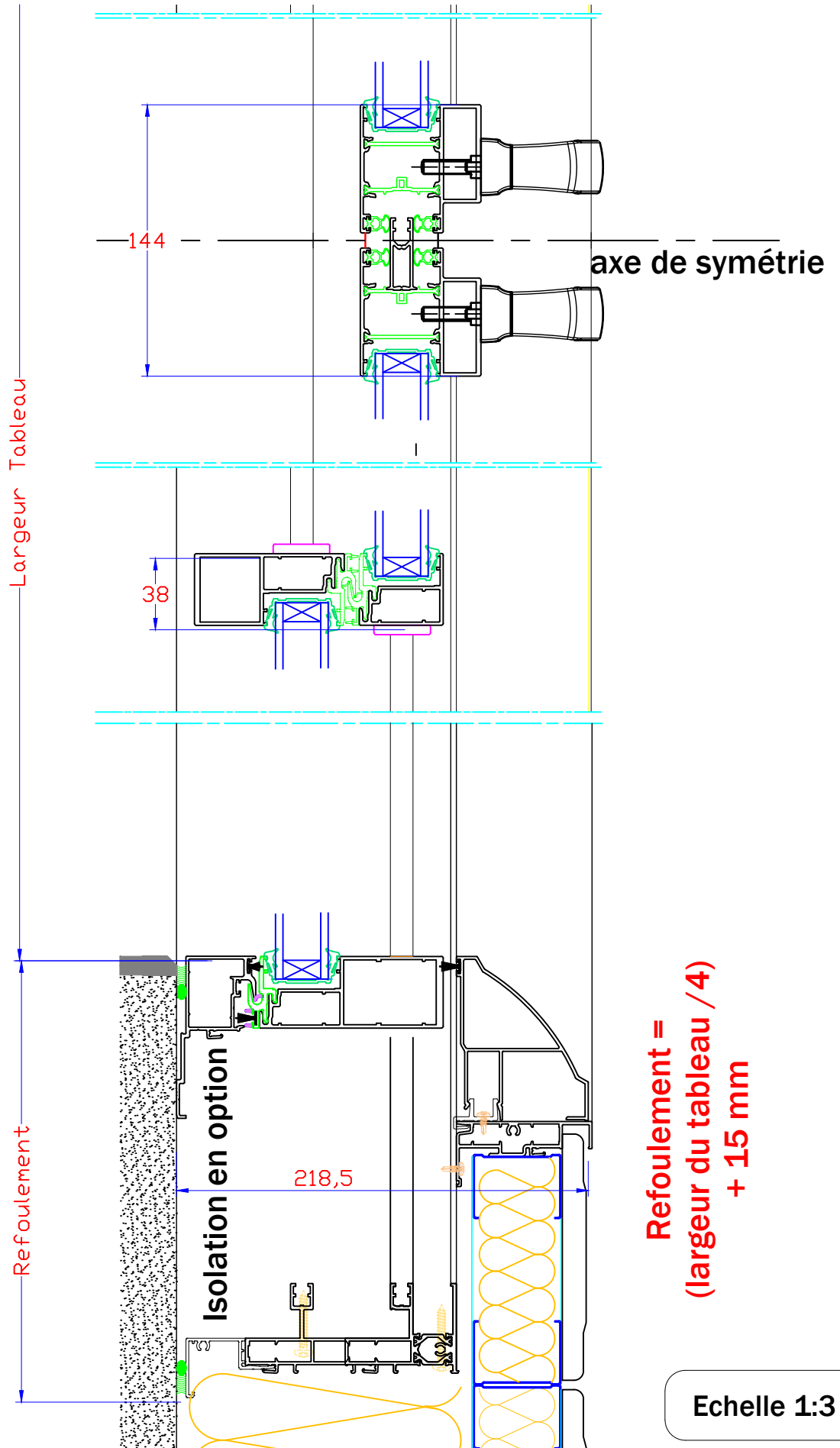

Vue en coupe verticale galandage bi-rail 2/4 vtx doublage 250 mm si VR

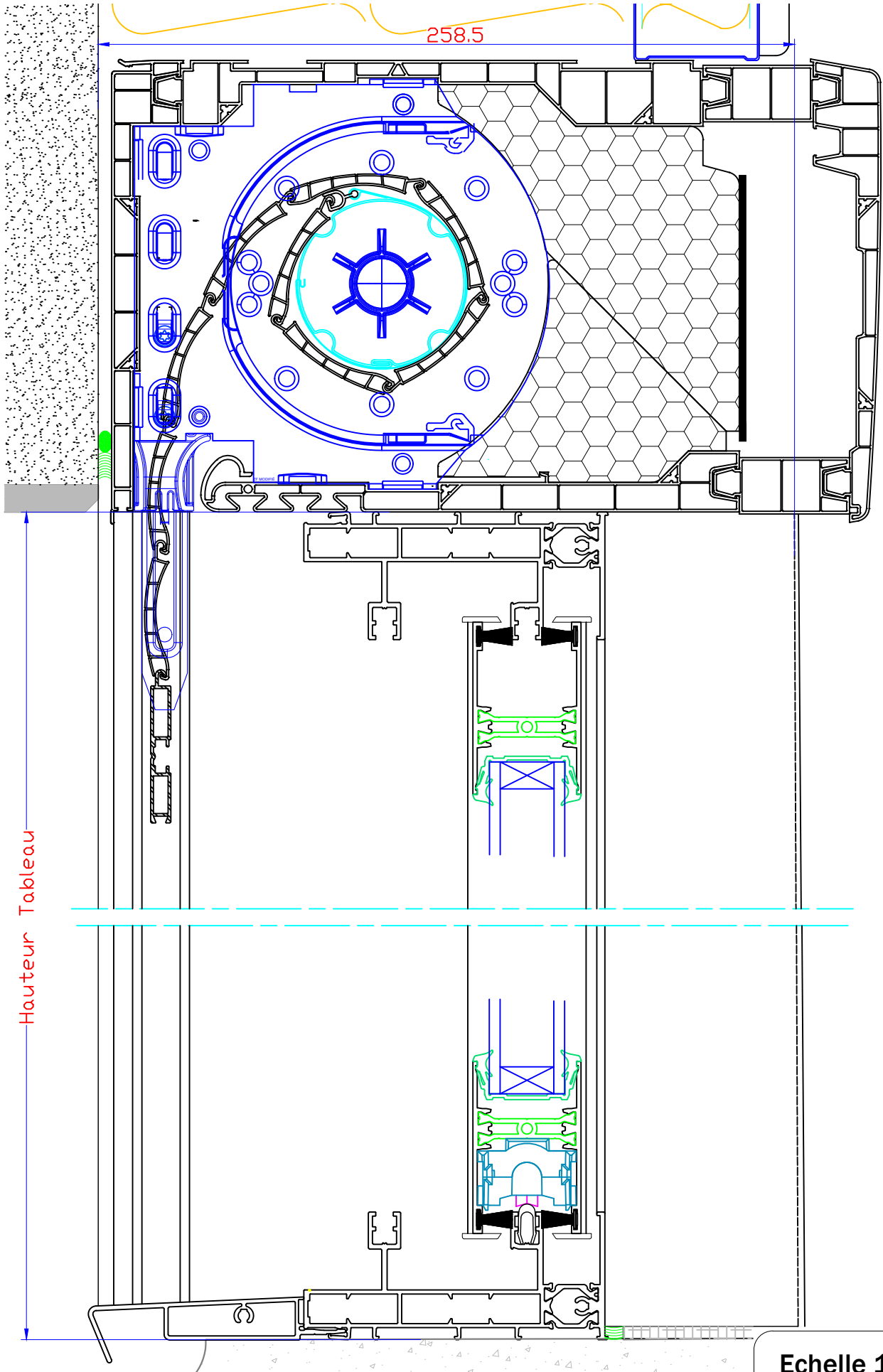

DOCUMENT NON CONTRACTUEL SUSCEPTIBLE D'ÊTRE MODIFIÉ

Echelle 1:2

Vue en coupe horizontale galandage bi-rail 4 vtx doublage 250 mm si VR

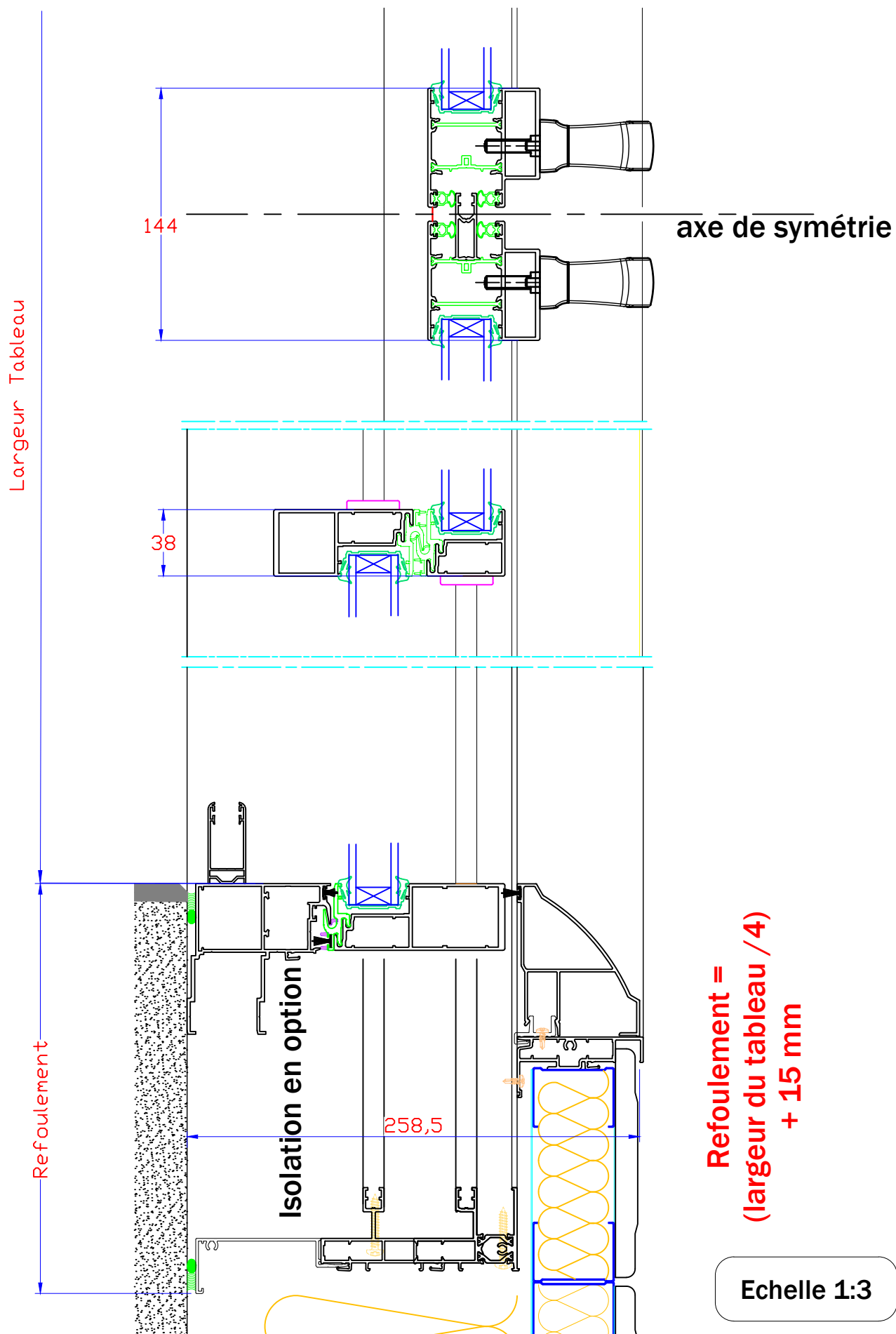

Vue en coupe horizontale galandage bi-rail 6 vtx doublage 270 mm

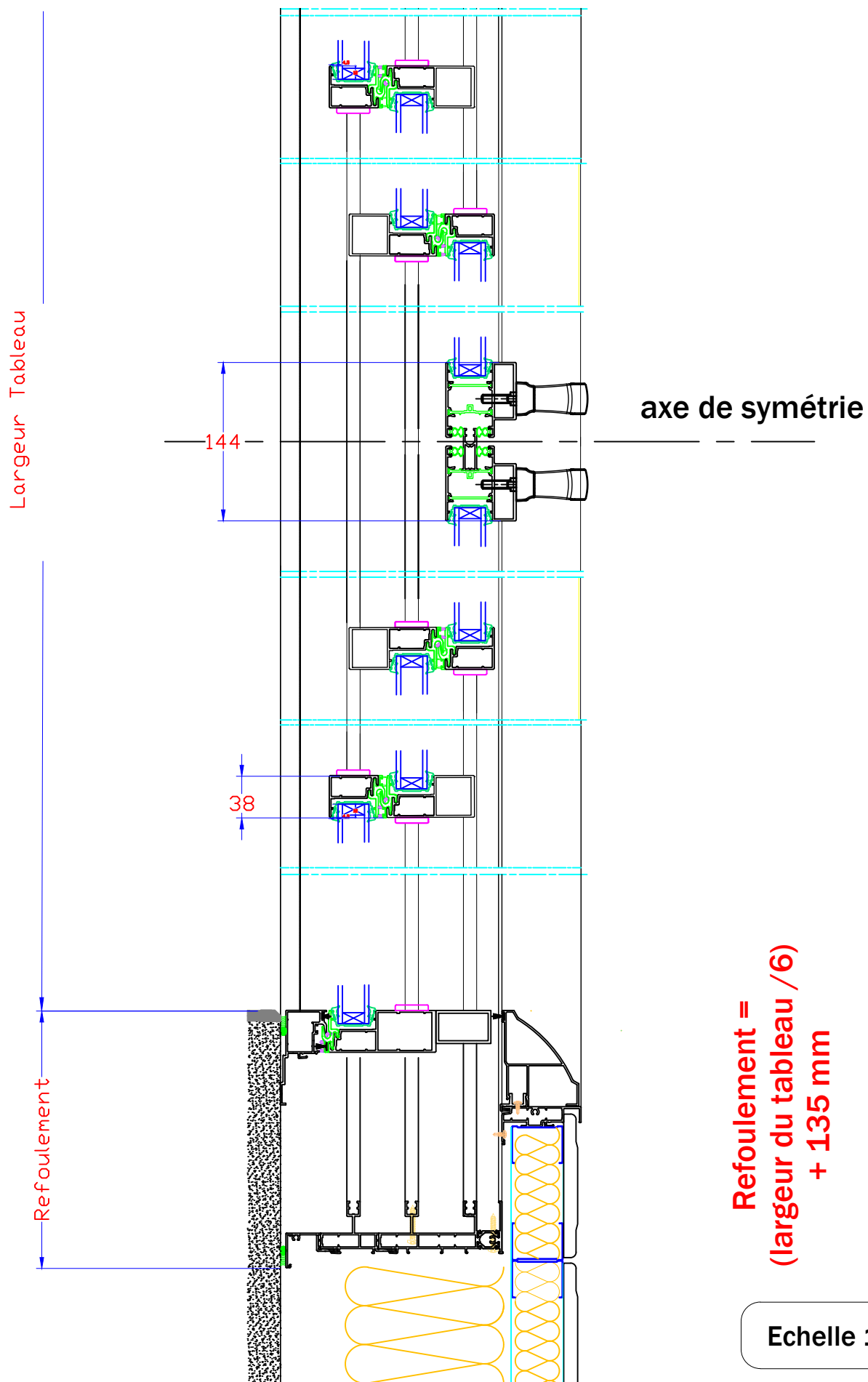

Calcul refoulement galandage

Galandage	Refoulement
Galandage 1 vantail DT 160 mm Crémone ou Serrure	$R = \text{Largeur Tableau} + 15 \text{ mm}$
Galandage 2 vantaux 2 rails DT 210 mm Crémone ou Serrure	$R = (\text{Largeur Tableau} / 2) + 20 \text{ mm}$
*Galandage 2 vantaux 1 rail DT 160	$R = (\text{Largeur Tableau} / 2) + 15 \text{ mm}$
*Galandage 4 vantaux 2 rails DT 210	$R = (\text{Largeur Tableau} / 4) + 15 \text{ mm}$
Galandage 3 vantaux 3 rails DT 270	$R = (\text{Largeur Tableau} / 3) + 125 \text{ mm}$
*Galandage 6 vantaux 3 rails DT 270	$R = (\text{Largeur Tableau} / 6) + 135 \text{ mm}$

Remarques:

_ Attention, prévoir également du jeu pour la mise en place des accessoires de poses

_ * Prévoir un refoulement à gauche et à droite

